

# Access Map

○ Nearest Station (Walk or bus)

■ Junctions

See campus maps for bus/walking routes from nearest stations.

EASIAM2018

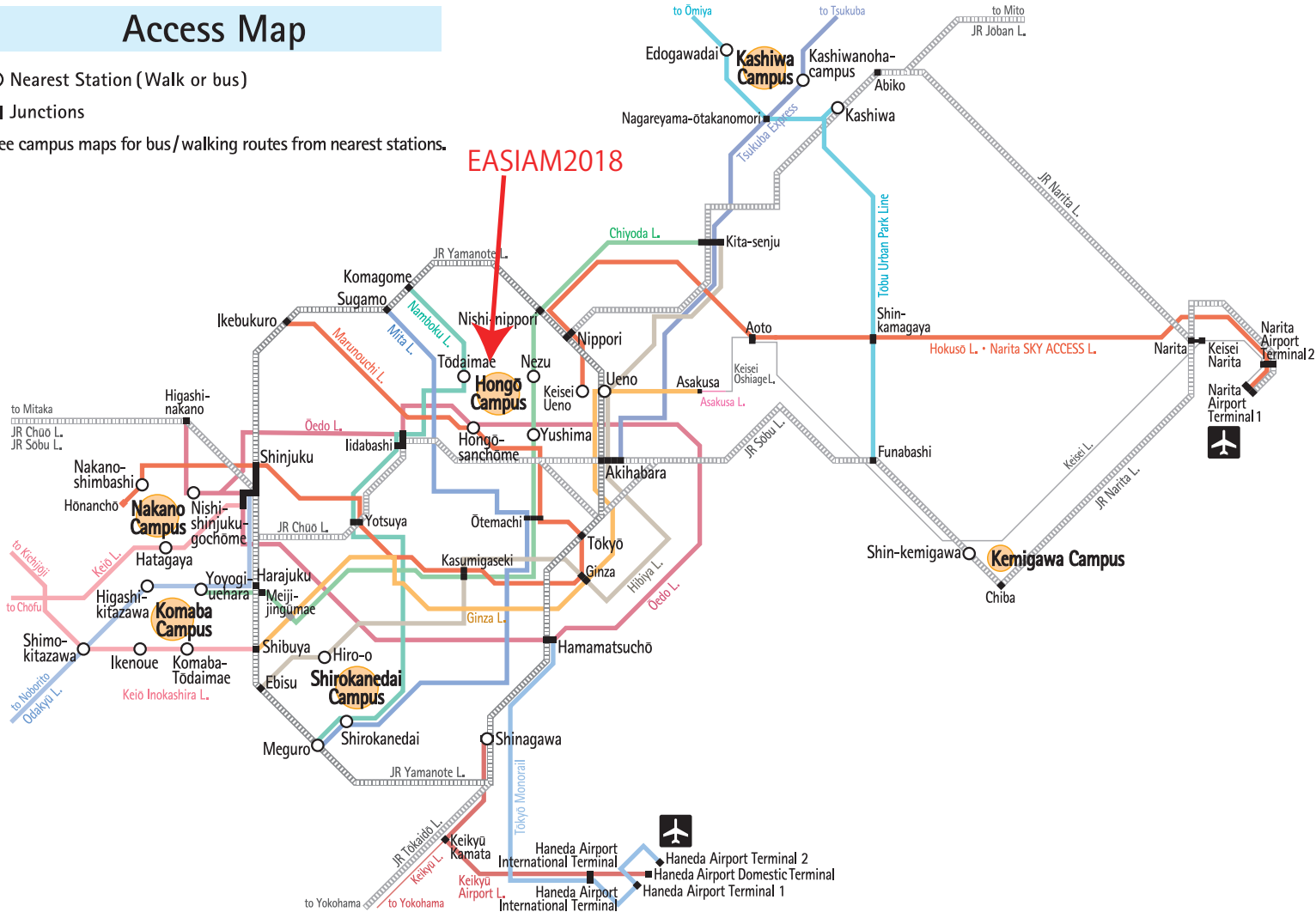

Google maps (@google)

To Todaimae subway station

To Nezu subway station

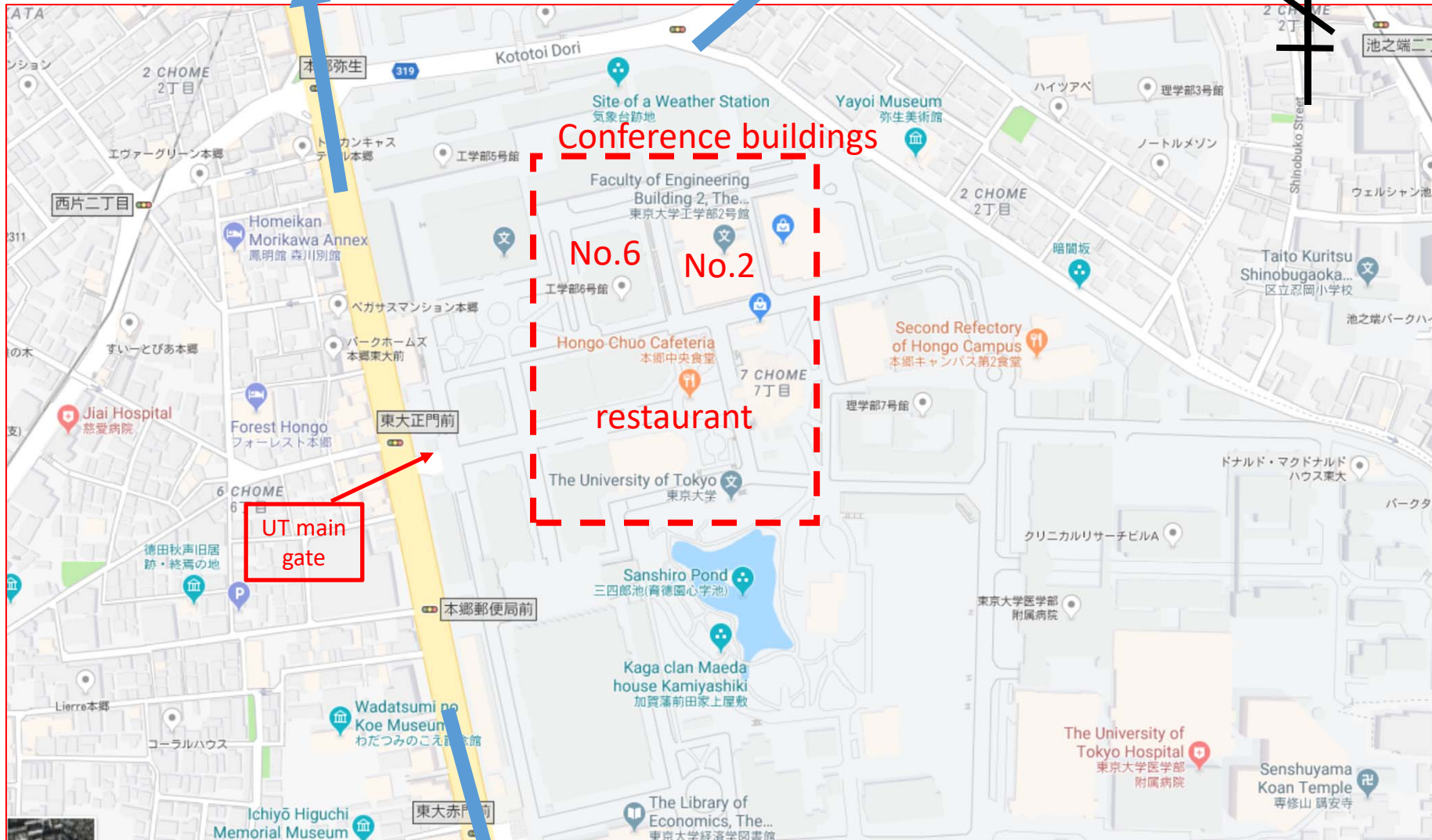

To Hongo-sanchome subway station

# Overall location map on Hongo Campus

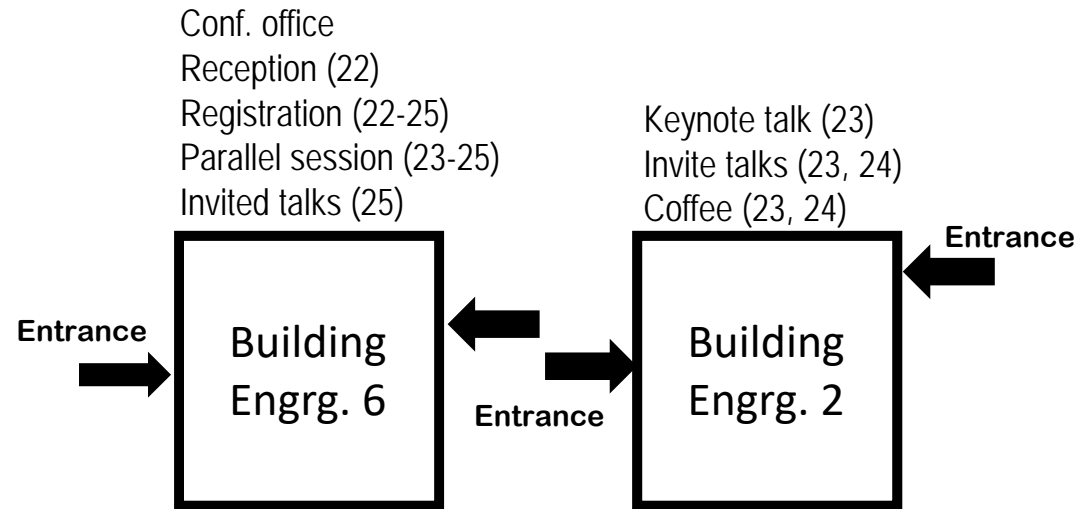

To the main gate

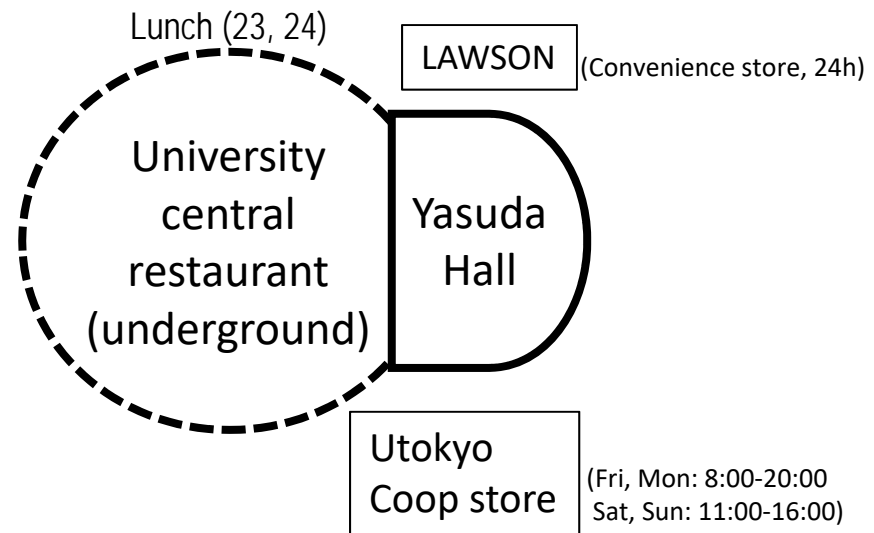

# Building Engineering No.6 (工学部六号館 in Japanese) , 3<sup>rd</sup> floor



[Colors]

22: preparation day

23: academic day 1

24: academic day 2

25: academic day 3

Main entrance  
(1<sup>st</sup> floor)

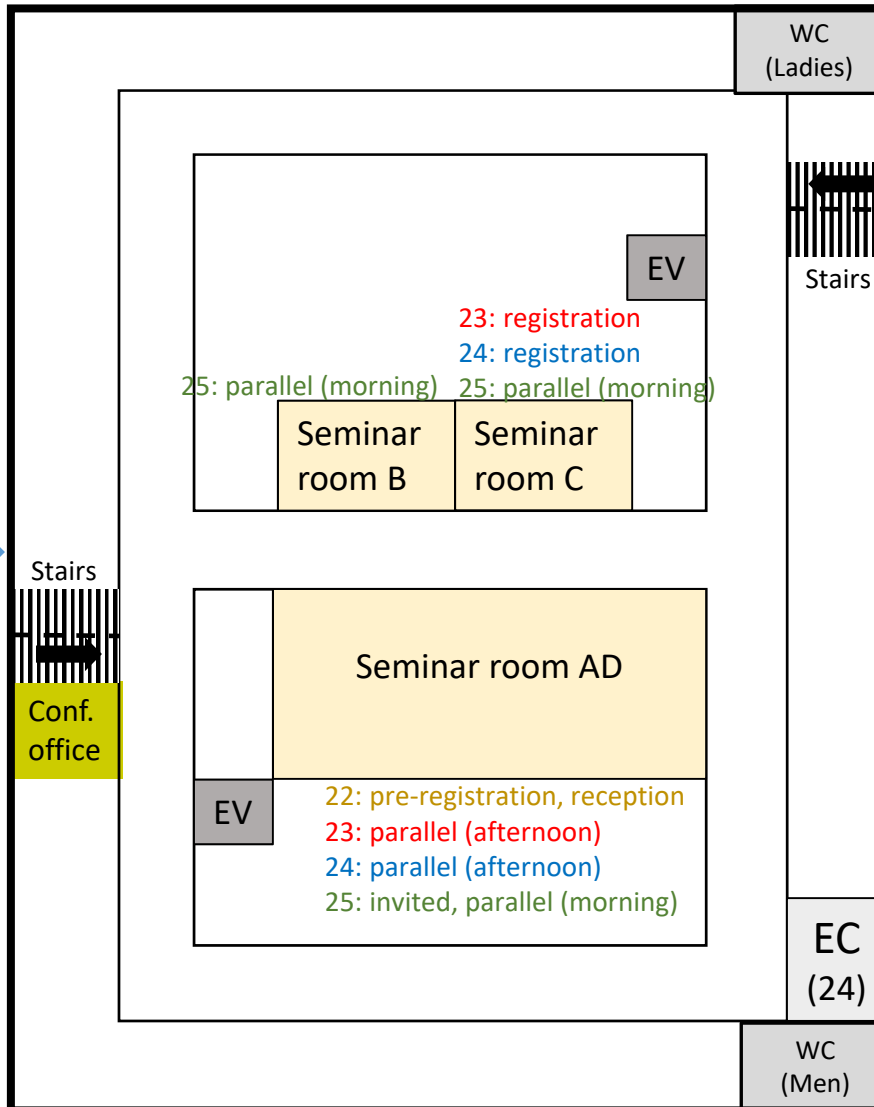
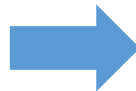

25: registration

Stairs  
Conf. office

25: parallel (morning) 25: parallel (morning)

Seminar room B Seminar room C

Seminar room AD

EV  
22: pre-registration, reception  
23: parallel (afternoon)  
24: parallel (afternoon)  
25: invited, parallel (morning)

EV

23: registration  
24: registration

WC  
(Ladies)

Stairs

To building No.2  
(basement floor)



- Message board is placed near the registration desk.
- When need help, come to the registration desk or the conference office.

EC  
(24)

WC  
(Men)

# Building Engineering No.6 (工学部六号館 in Japanese) , 2<sup>nd</sup> floor



[Colors]

22: preparation day

23: academic day 1

24: academic day 2

25: academic day 3

Main entrance  
(1<sup>st</sup> floor)

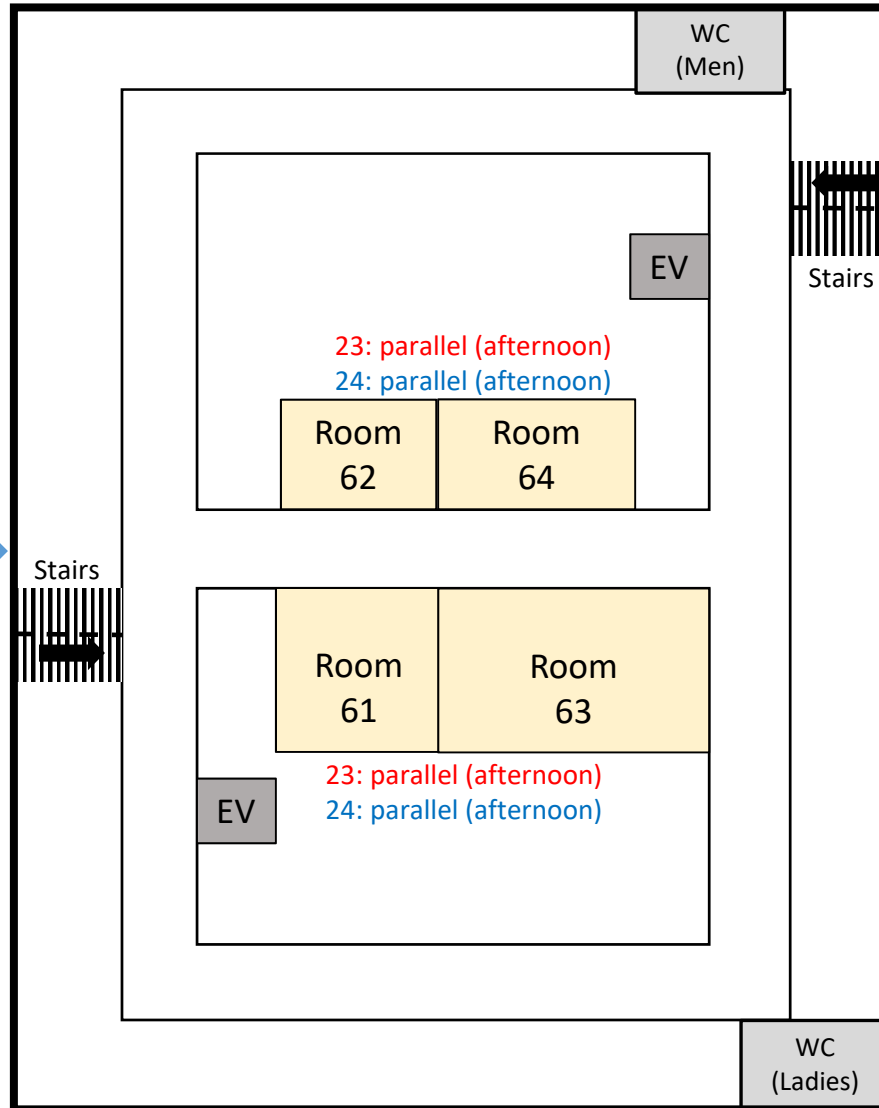
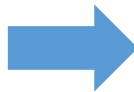

To building No.2  
(basement floor)



# Building Engineering No.2 (工学部二号館 in Japanese) , 1<sup>st</sup> floor



[Colors]

22: preparation day

23: academic day 1

24: academic day 2

25: academic day 3

To building No.6  
(2<sup>nd</sup> floor)

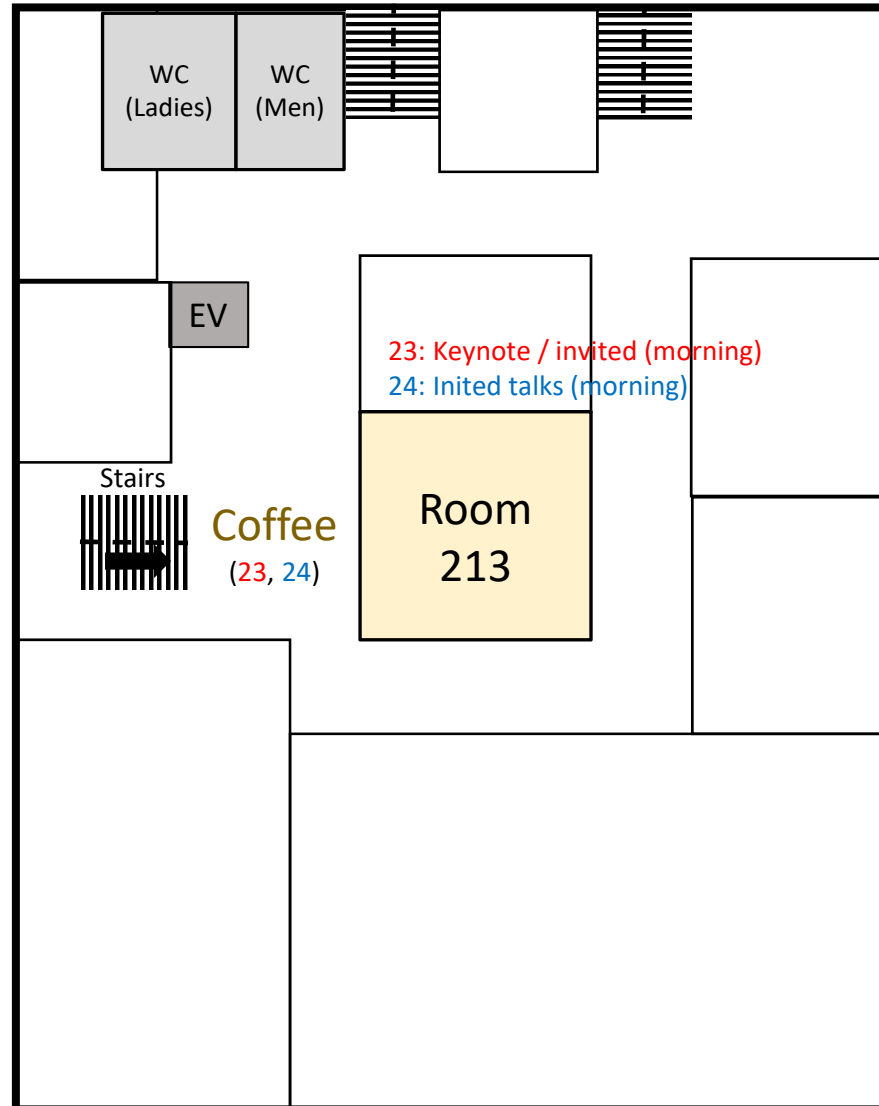

Entrance  
(1<sup>st</sup> floor)

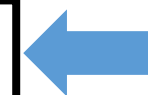

23: Keynote / invited (morning)  
24: Inited talks (morning)

Room  
213

Coffee  
(23, 24)



EV

WC  
(Ladies)

WC  
(Men)